

SLT requirements, for new school.

- ① Desk / space to write up notes
- ② Space to store equipment (built in cupboards ideal as current space very cluttered and messy)
- ③ Space to meet with parents in private as so much of our work is done in consultation with them and staff members.
- ④ Access to EMIS (need good wi fi signal!!) As all our notes are electronic + diary. May require a box to boost signal if this isn't good on new site.
(Can't access ~~the~~ education wi fi as systems won't allow)

Outdoor spaces

Garden area / Picnic area, PE area.

Nature / Nurture zone,
Wheelchair swing / roundabout,
gym trail
outdoor exercise equipment.

- bikes storage
- outdoor storage for bikes, tools.
- hobbit house.

Wheelchair tunnels, bumps, traffic lights.

Senses

enclosed area?

Staff
Car Parkings

Water
Parkway

Bus / Taxi

Parkings,

Not near road.

tennis court
badminton "
zone

High fences !!
fully enclosed !!

Covered Outdoor Area
Raised beds.

Greenhouse. - wheelchair accessible

Specialist spaces

Appropriate lighting: adjustable / adult control only.

Frequencies to be considered for ASD pupils

Quiet Forest (Nature Area).
Grass area.

Sensory Room

Staff work base

Staff room + outdoor eating / rest area

eg picnic bench

Office

Near front door / reception area.

Keyfob access for all doors.
or Swipe card.

Sliding doors to outdoor space

Double width window,
ceiling height + good acoustics.

toilet facilities

Gym

Hydro pool
large pool! jacuzzi
+ splash zone

Soft Play

Rebound
Therapy

Home Ec

high / low
tables
+ cooler
sink etc

All areas to have
lock down ability

Self service?

Lunch facilities

Primary / Secondary
Canteen, messes.

PE hall

Assembly hall

Carpeted areas.
NICE!

Music + lighting effects

Classroom

changing bed

Art area

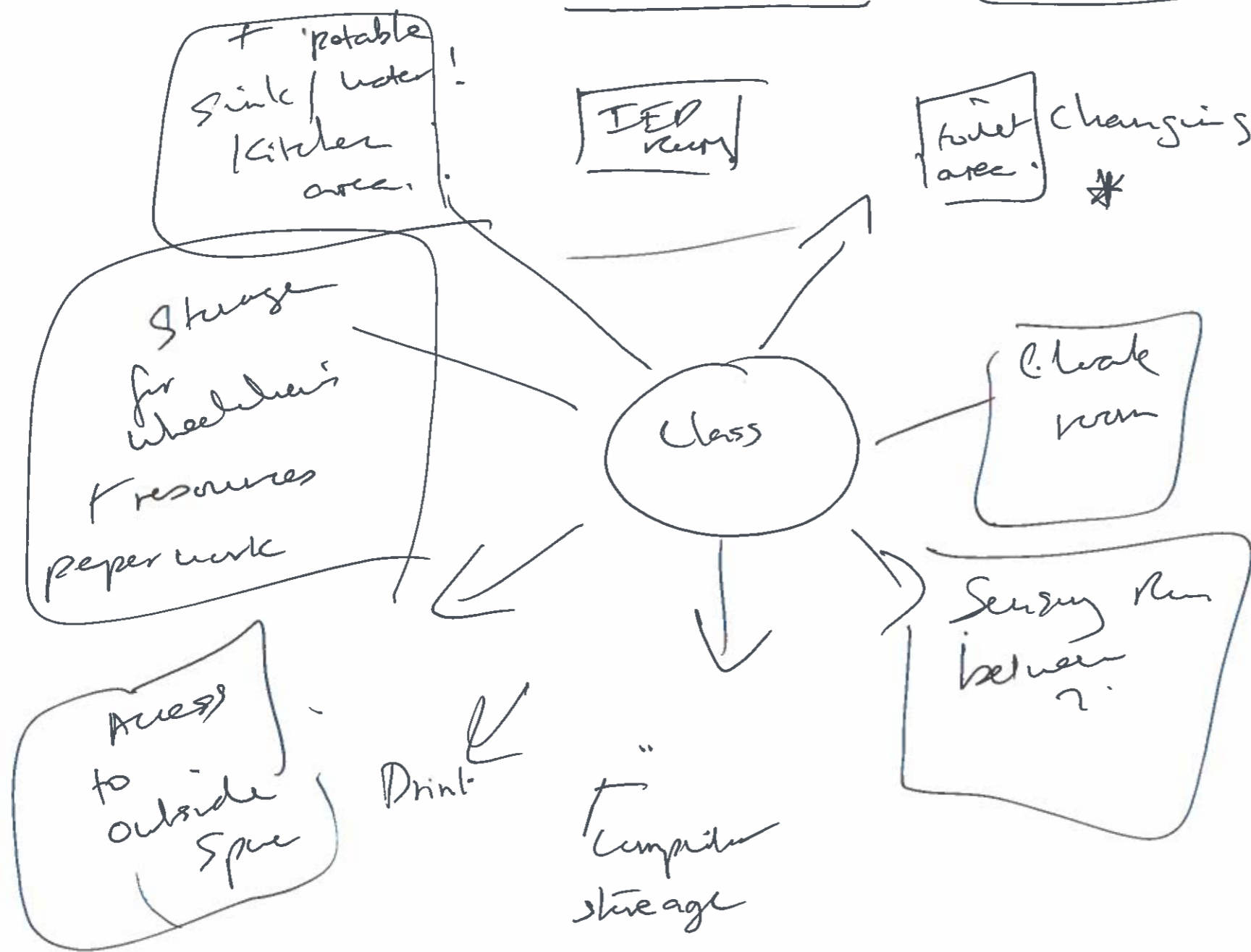

Assembly Amphitheatre?

Calan Rooms in few areas.

Intercom ??

what are alternatives: as can be disruptive to learning & teaching.

Travelling for hoist

Travelling for wheelchair

Black out blinds.

Physio Room. + soft floor.

OR Sink & J.I.I style toilets

Resource for nurse

Beds

or /

Science

Specialist spaces

↑ proper changing facilities

↑ hoist access to entrance of pool

- full size swimming pool plus a hydro pool
- fitness suite for senior school (mostly) - treadmill, cardio, rowing, stationary bike
- gym hall with storage + apparatus → rebound therapy area
- music room - suitable acoustics - storage for music instruments / equipment
- each classroom to have 'quiet room' and storage area for equipment for children in chairs
- 'quiet areas' around school - padded with Nothing assistance inside for distressed children.
- Toilet area / changing room for each class or between 2 classes.
- Therapist room with equipment - 'physio room' and room for children to practice walking.
- Dance / movement studio.
- Each classroom path area (covered) and access to outdoor area.
- double length corridors for chairs. (two average wheelchair width)
- ramps.
- safe play (large) 'age appropriate' for older children.
- SENSORY room AND snuggly room OR light therapy etc. Separate 'magic carpet' room

Changing bed

Cloak room

COVERED SECURE

↓ play

magic carpet room

- lunch hall (split) junior and senior.
- Junior and senior separate area in playground.
- NO light switches that our child accessed just remote or by key
- easy access for wheelchairs (walkers) / school chairs to go outside
- Woodland area outside
- Fobs to get through main consider doors and
- WiFi / classroom doors
- playground / bike area
- ICT suite with Smartboard / touch screen
- CAR PARKING
- bike storage.
- Assembly hall with low ceiling
- BRIS BAYS / TAXI AREA
- Sensory garden
- STAFF PARKING
- Grassy outdoor space
- gardening areas
- toilets for staff - mac! functioning staff room (LARGE!)
- LAUNDRY FACILITIES / Storage for sport clothes / towels / etc.
- Hoist TRACKING / CEILING HOIST
- WALL CLASSROOMS
- HoISTS IN ALL SENSORY AREAS (CEILING HOISTS)
- Staff working area separate to adequate resource storage.
- HE ROOM - proper equipment different stations
- Recycling area
- Meeting / parent room
- Growing area - glasshouse - ~~not~~ but not glass rooms for management staff (3)
- music outside
- medical room / nurses
- chill out / area for older children (senior) recreation
- life skills room / flat for older kids to learn how to work etc
- outdoor play - sand pit
- outdoor sensory areas
- more play equipment for children
- garden house
- paddock - play equipment for ambulant children
- roundabout (wheelchair accessible) specialist swings.
- 'jumping pillows' outside trampolines
- sheds (outdoor storage)
- trim trail / climbing environment

|| touchscreen
in every room ||

Learning + P.E/Activity Spaces

- Tracking for hoisting in each class.
- Blinds in between glazing for option of blackout
- Quiet ~~rooms~~ rooms attached to every class.
- Electric windows + blinds
- Resource + physical equipment storage attached to every class.
- Sinks (children's height + adults height) in each room.
- Secure outdoor space (preferably sheltered) attached to every class.
- Kitchen area in each class.
- Lighting with dimmer and remote switches
- Toilet + changing room attached to every class.
- Lockable doors
- Dark room / sensory room for each class.
- Separate P.E. Hall - specific for sports with changing facilities attached.

Outdoor space and additional features

- A mix of green space and soft flooring outside
 - Sensory garden
 - Covered areas
 - Outdoor storage (for bikes etc)
 - Feature areas e.g. mud kitchen, adventure area, water play area.
 - Equipment for primary + secondary equipment
 - Small pitch
 - Separate outdoor area for nursery
 - All areas to be wheelchair accessible.
- All areas sectioned off (gated areas).
- Big enough for a few classes out at once.
 - Outdoor sandpits.
 - Road markings on soft outdoor area.

• wheelchair specific area in playground.

Additional features

- Parents' room (for social purposes)
- Meeting room (for reviews etc.)

Specialist spaces

+ circulation + shared space

- More than one cooking room (Home Economics).
- More than one hall - canteen / P.E / big hall (with stage) for shared activities. Gym for senior pupils.
- Double width corridors for wheelchairs and possible class activities.
- Music / Art / Drama (stage) rooms (soundproof music room)
- Clean area + private area for nurses + changing room + toilet
↳ for clinical work
- Physio exercise room / speech therapy room.
- Messy room (which could be hosed down e.g. messy art)
- Hydrotherapy / splash + big pool (separate area for each pool)
(4 shallow)
- Soft rooms in each section of school (calm zone + observation room)
- Tracking in changing rooms with cubicles.
- More than one soft play and more than one sensory studio
- Own kitchen (not food from High School) to suit diets of our own children.
- Bigger staff room - for all staff comfortably.
- communal area - higher ceiling (not too high)
- Air con for big spaces
- work surfaces
- communal resource room
- Laundry
- Big car parking area with # specific bays for taxis and buses.
- Heating which can be controlled in school / Air conditioning
- Rebound therapy room.
- Intercom system
- Adjustable height smartboards.

PE/activity spaces

- Hydro-pool and Swimming pool (min 10 metres). Tracking and hoisting down to pool.
- Good changing room facilities ie. bigger, wet room shower, accessibility to towels, swimming costumes, dry area for hair to be done etc.
- Splash pool (with above changing facilities).
- Soft play with air conditioning, tracking and accessibility toilet.
- Fitness suite - treadmill, parallel bars, reclining bike, cross trainer etc (tracking)
- Gym hall with partition and large equipment cupboard. Ceiling should be high enough for trampoline. Doors that lock. Seperate room so no passage-way.
- Sensory room - big enough for more than one wheel chair (with tracking)
- Outdoor play area - space to run, trim-trail, bike-riding area etc. - track painted on tarmac.
- Accessible storage areas (designated areas for outdoor learning)
- Sensory garden area
- Outdoor areas must be enclosed with high fences.
- Fob to open gates rather than padlocks or bike locks.
- Covered stage area that could be used for stories / drama etc.
- No glass roofs (too hot!).
- Physio area off each class - ~~multi-purpose as it could be used for~~ IEP room off within each class, changing rooms / toilet in each class.
- Home Economics room that is accessible for wheelchairs. (wide enough to move round tables, sinks that go up and down etc).
- Music room - sound-proof.
- Art room - with space to store all the art materials
- Relaxation / Yoga room (quiet room that can be easily blocked out (with noise canceler)).

- Bowling alley.
- As much space as possible inside and out
- Varied surfaces eg. slopes, bridge, stairs
- Assembly / lunch hall (not with high ceilings as acoustics cause sensory issues with our pupils).
- No strip lighting - appropriate lighting for each area eg. dimmer switches for classrooms.
- Lots of accessible storage spaces.
- Shop / role play area with working till so pupils can practise buying things without having to go out all the time.
- Designated gardening / planting area with raised garden beds for wheelchair users.
- All areas accessible yet secure.
- Parents' / meeting room.

Circulation and shared space

One school - three distinct faculties
 Tracking throughout school
 each class a partially covered courtyard garden (enclosed)

Large shallow cupboards in each room - equipment storage

a couple of gym balls

Physio rooms on sight kitchen to cater for CV children

3 sensory studios + soft plays. outside learning / picnic areas.

Staff areas - in door + out Staffrooms

parent rooms - private spaces

Doors that open and close - for entry to all the rooms

Indoor play areas - for rainy days.

Two hydro pools

lots of toilets - for staff as well as pupils (flushing please)

lots of parking - taxis and buses.

Well fenced playgrounds

P.E area. including fully equipped gym

ventilation system that doesn't make a noise.

Storage space in
 classroom for equipment.
 ie standing frame, wheelchair,
 class chairs

lighting

All outdoor wheelchair
 equipment in same area

flooring

3 chill out rooms

Separate lunch halls

Car park

Area for taxi's

Wide corridors.

fully equipped + accessibility
 for all at home economics

lots of storage space

more wheelchair swings
 in playground.

Changing facilities is attached to each
 classroom

Better disposable uses

for nappies etc.

large laundry / sluice

outside green area

Sensory Garden

Circulation and shared space

Parking for staff - taxis, buses. - separate areas for taxis, buses, staff.

Good sized gym hall

Assembly / lunch hall

wide corridors

changing rooms off classrooms (if not - more changing rooms + shower facilities)

Sensory area within classroom

Isobel Mary Cottage

Splash pool

hydro pool

good changing facilities eg. small cubicles / changing beds, hoists etc. ^{Tracking}

Large outside space outside each classroom / space for equipment (wheelchairs, walkers, etc)

Soft play - Tracking + hoists.

Decent laundry with sluice

Soft lighting

Large outdoor space

Equipment to climb / play, explore, balance - wheelchair access

Easy access to different areas that is childproof (Not combination locks as we have now)

Sensory Garden

Basketball / football fenced off high area with a gate.

Trampolines fitted into ground.

Staff toilets with windows. Toilets that flush.

On site kitchen. (cooking)

Space for when therapists come in to see children.

Home Economics Room.

Outside learning area gardening etc.

Picnic areas.