

# EAST DUNBARTONSHIRE ASN SCHOOL

# Workshop 3 // Introduction

## Key Features





# Workshop 3 // What have we been up to

## Listening and Implementing !

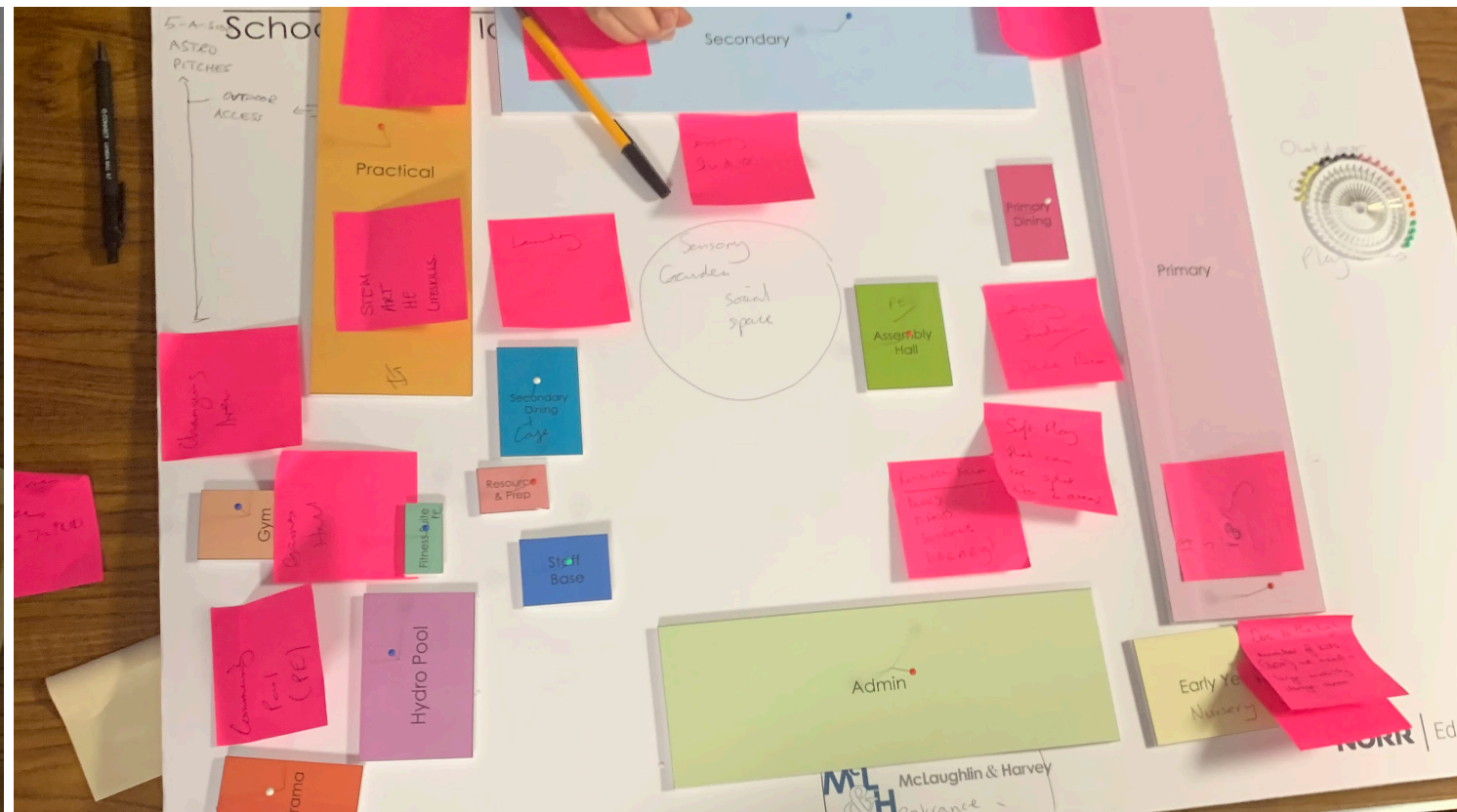
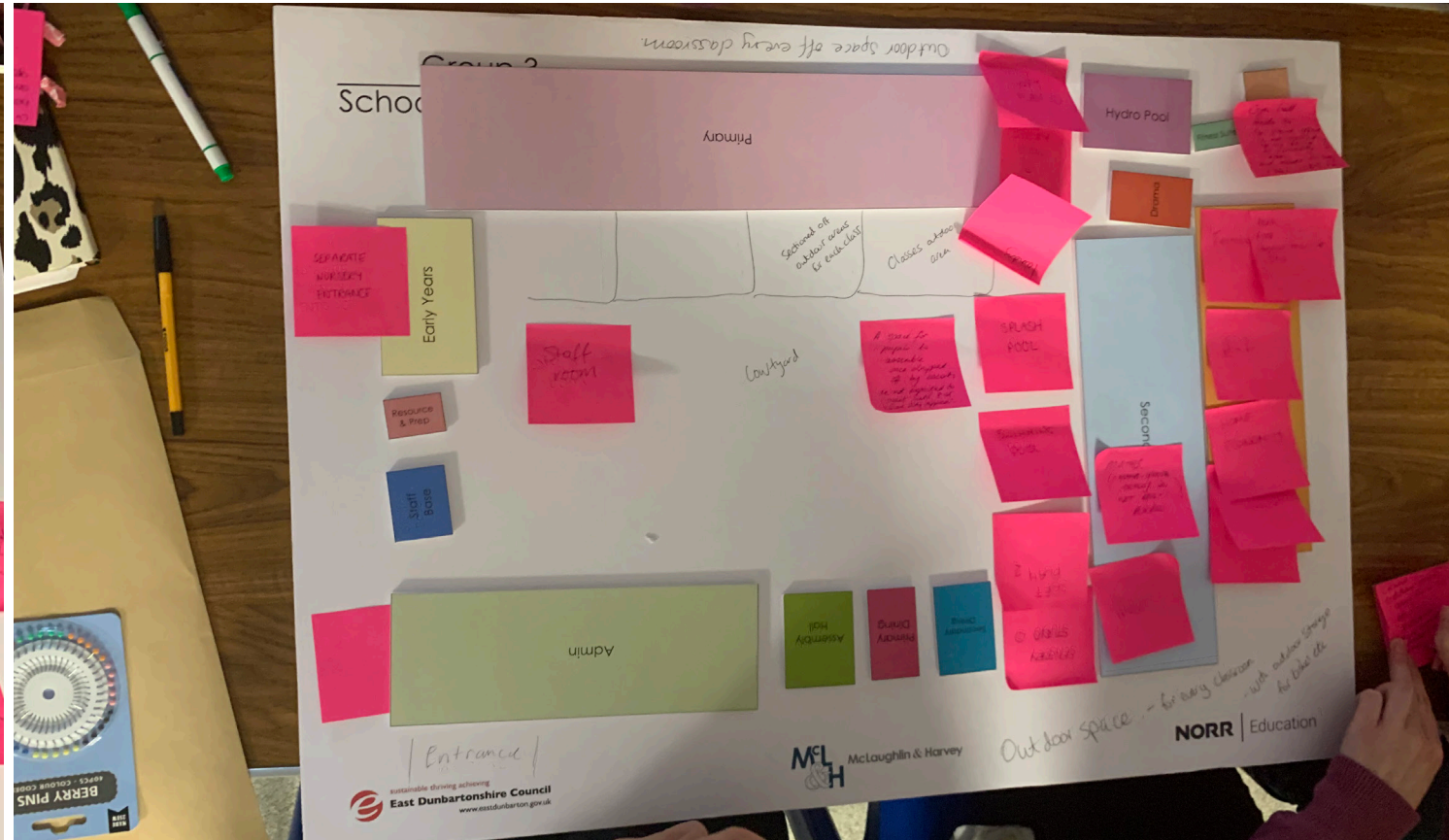
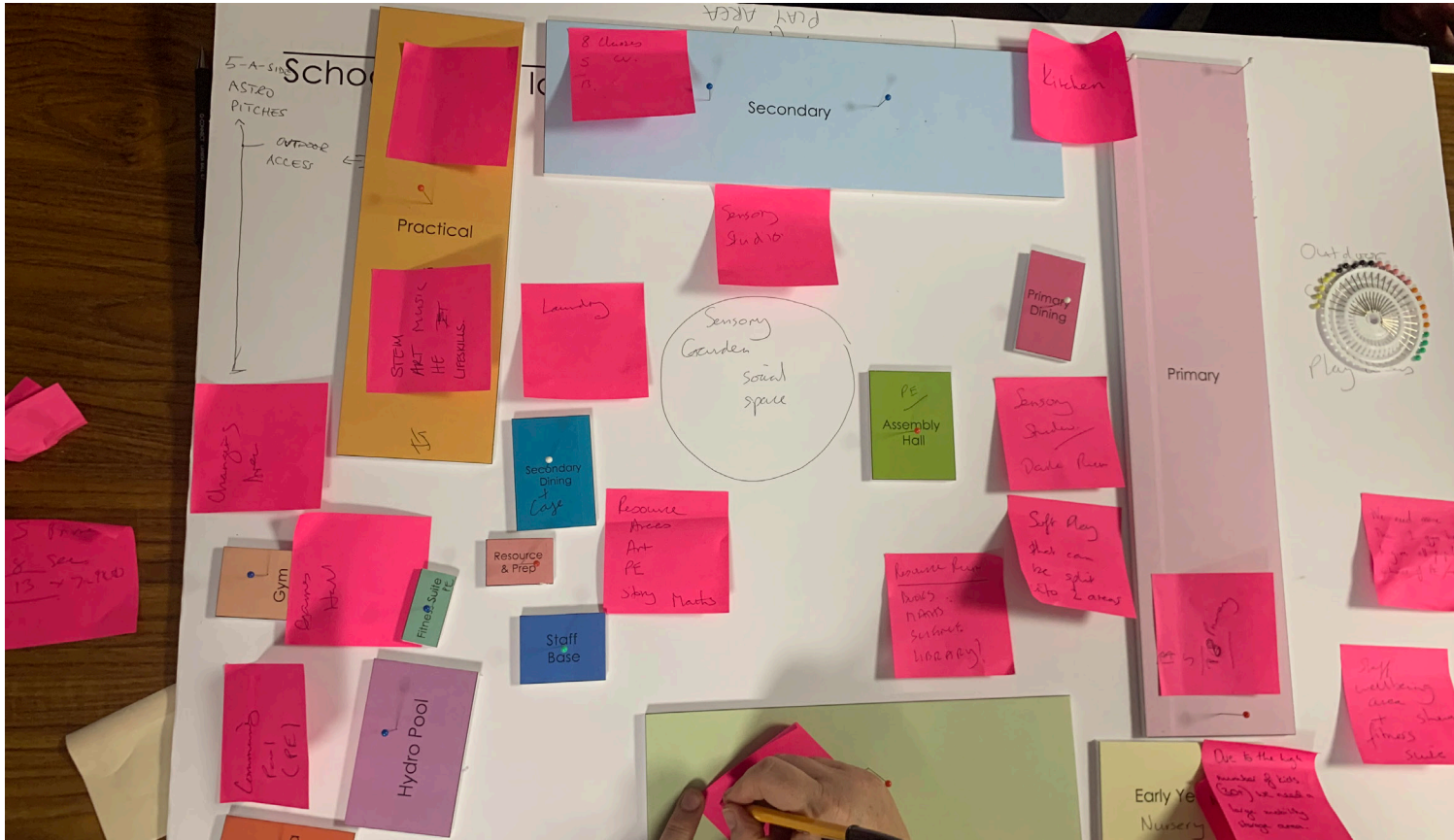



Workshop 3 // Classroom Clusters 01

Workshop 01 Outcome in Detail - Type S1

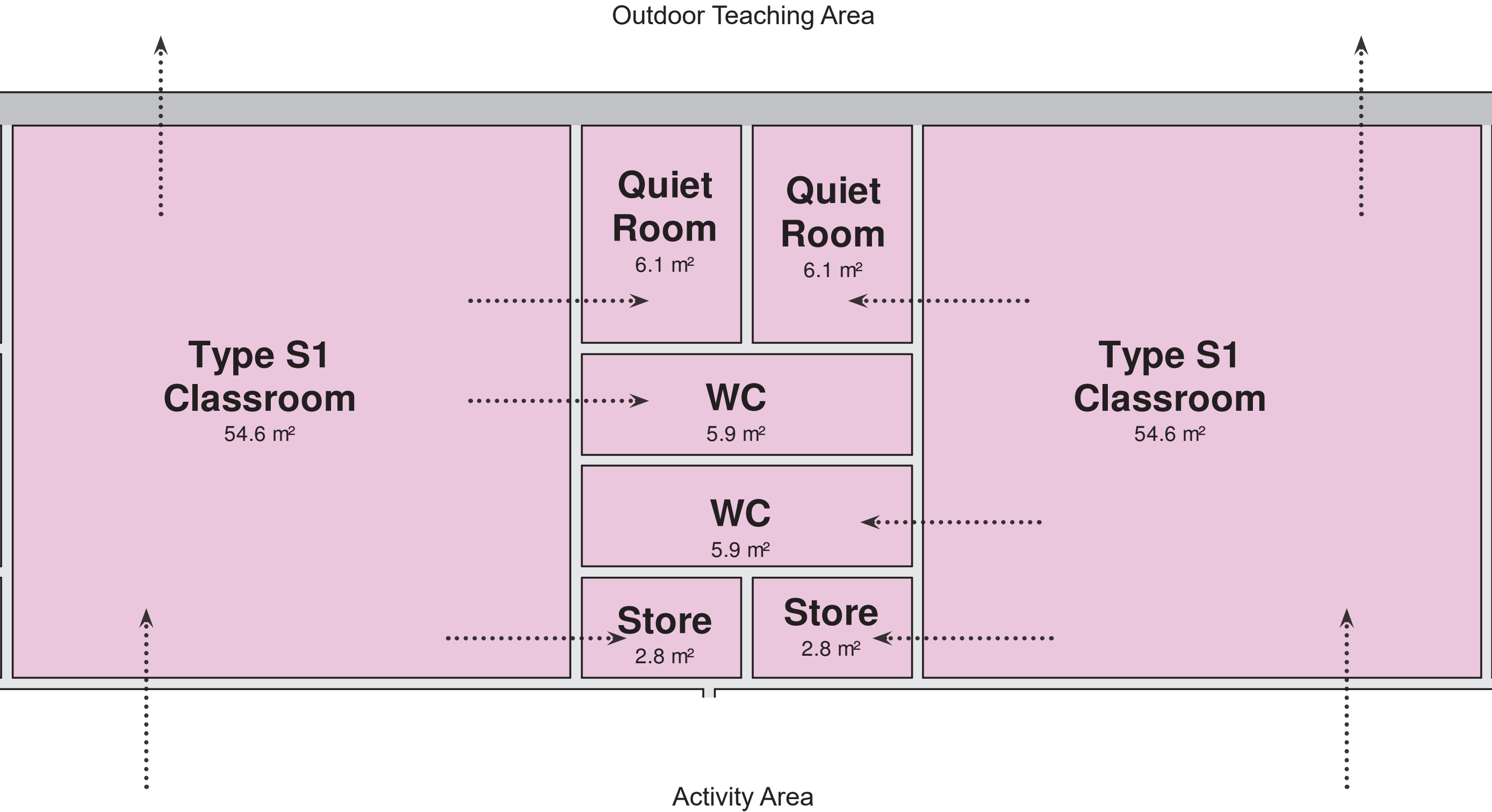

Workshop 3 // Classroom Clusters 02

Workshop 01 Outcome in Detail - Type S2

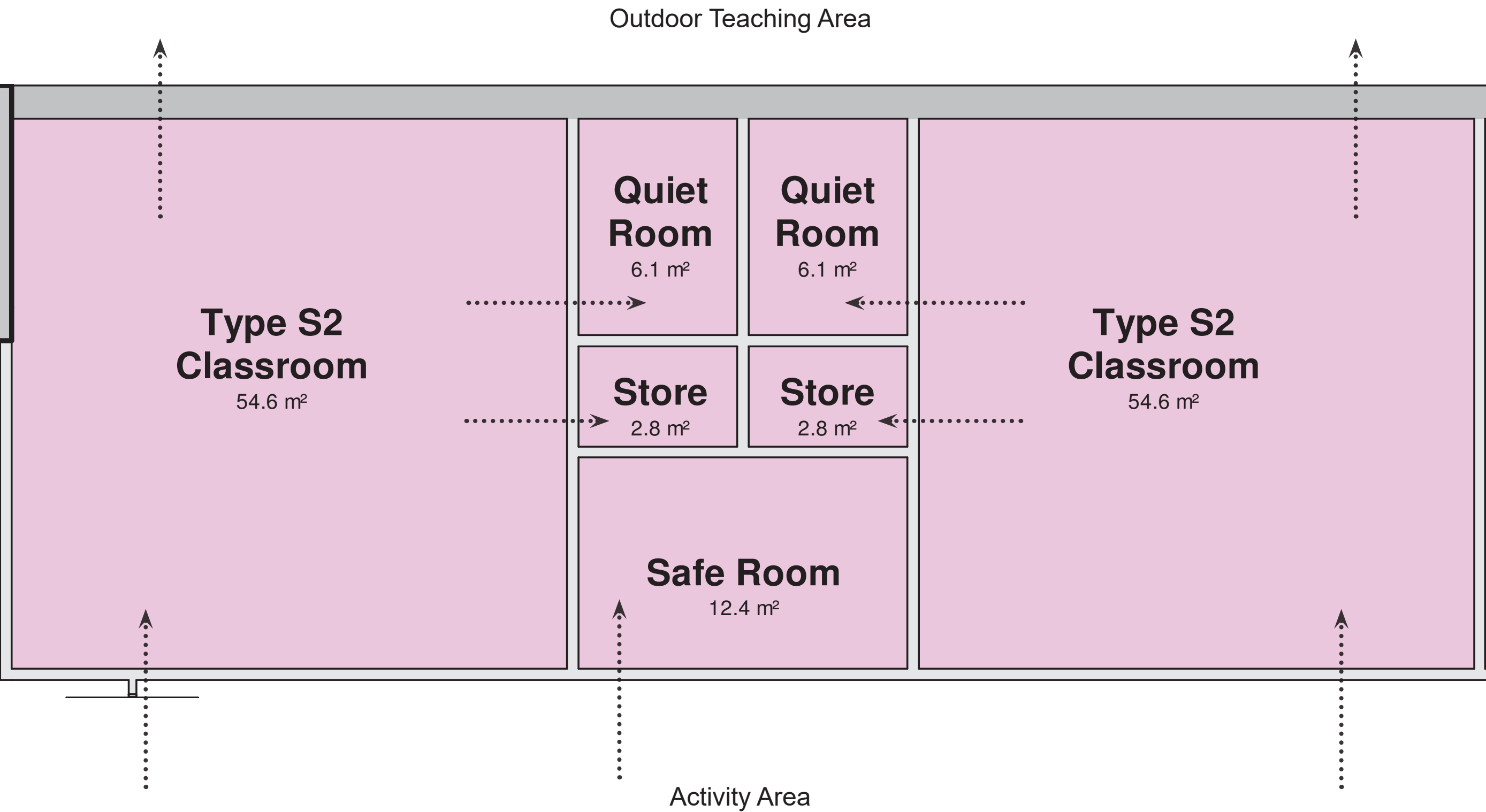

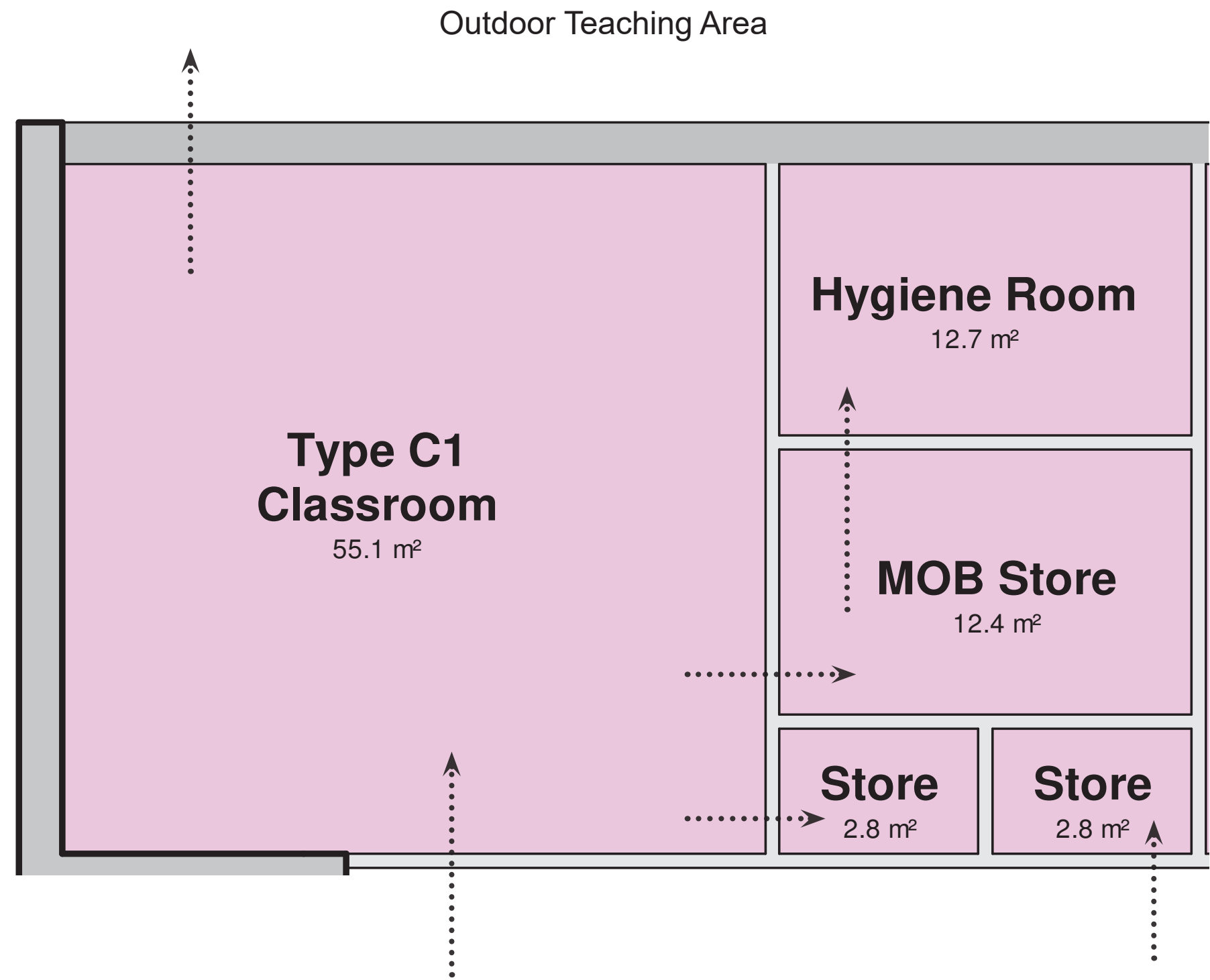

**Workshop 3 // Classroom Clusters 04**

Workshop 01 Outcome in Detail - **Type C2**

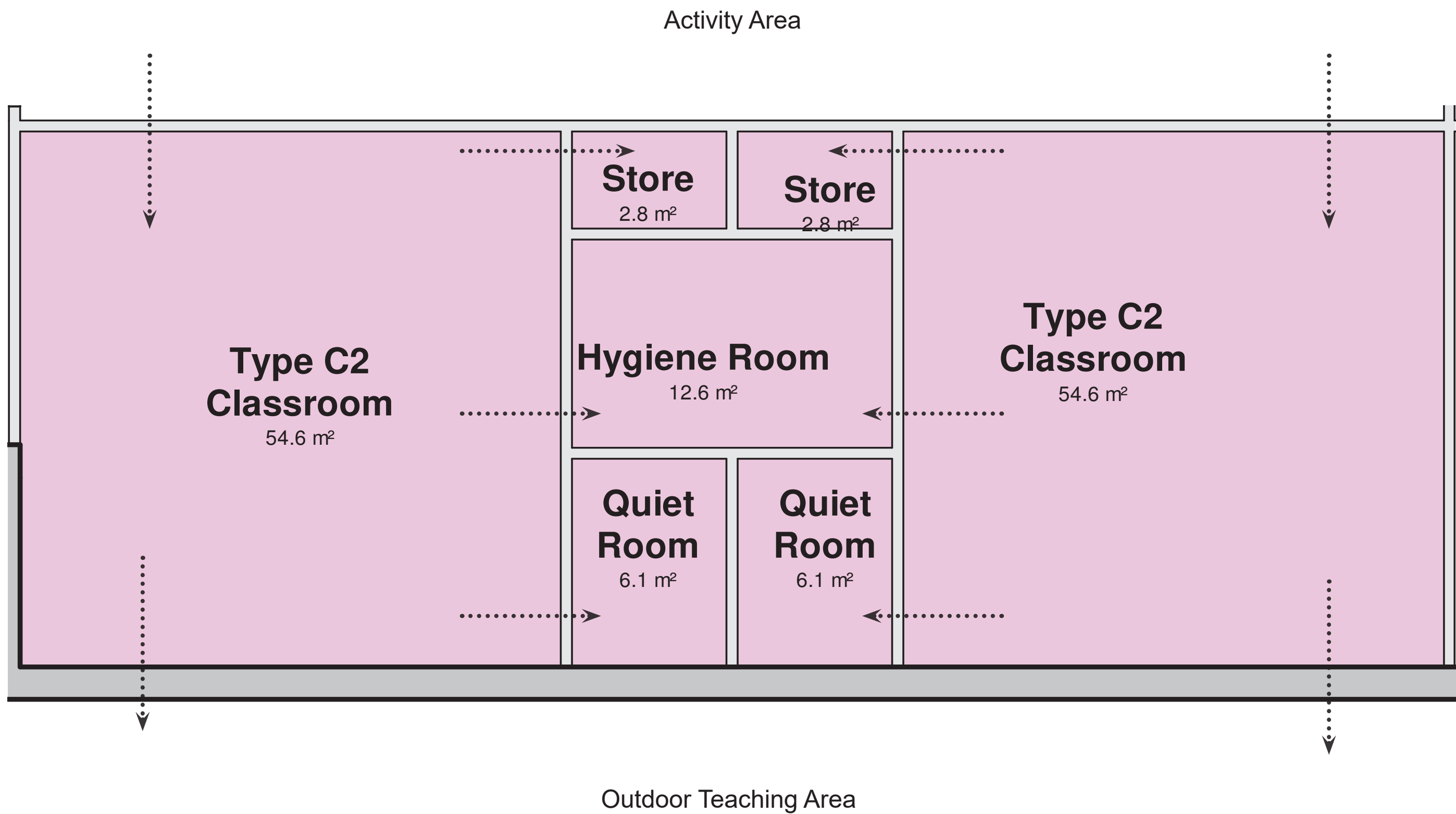

**Workshop 3 // Classroom Clusters 05**

Workshop 01 Outcome in Detail - **Type C3**

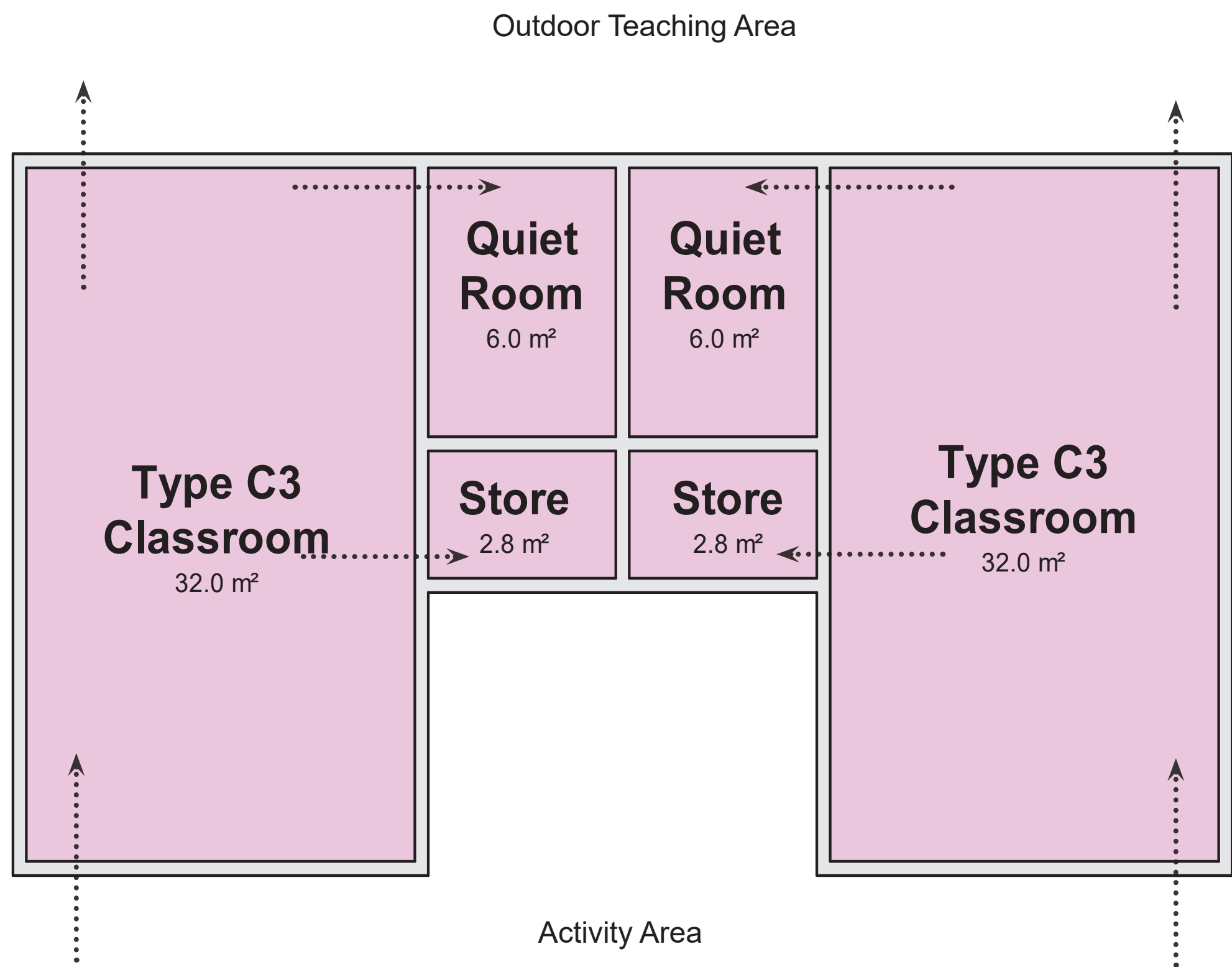



# Workshop 3 // Site Arrangement

## Site

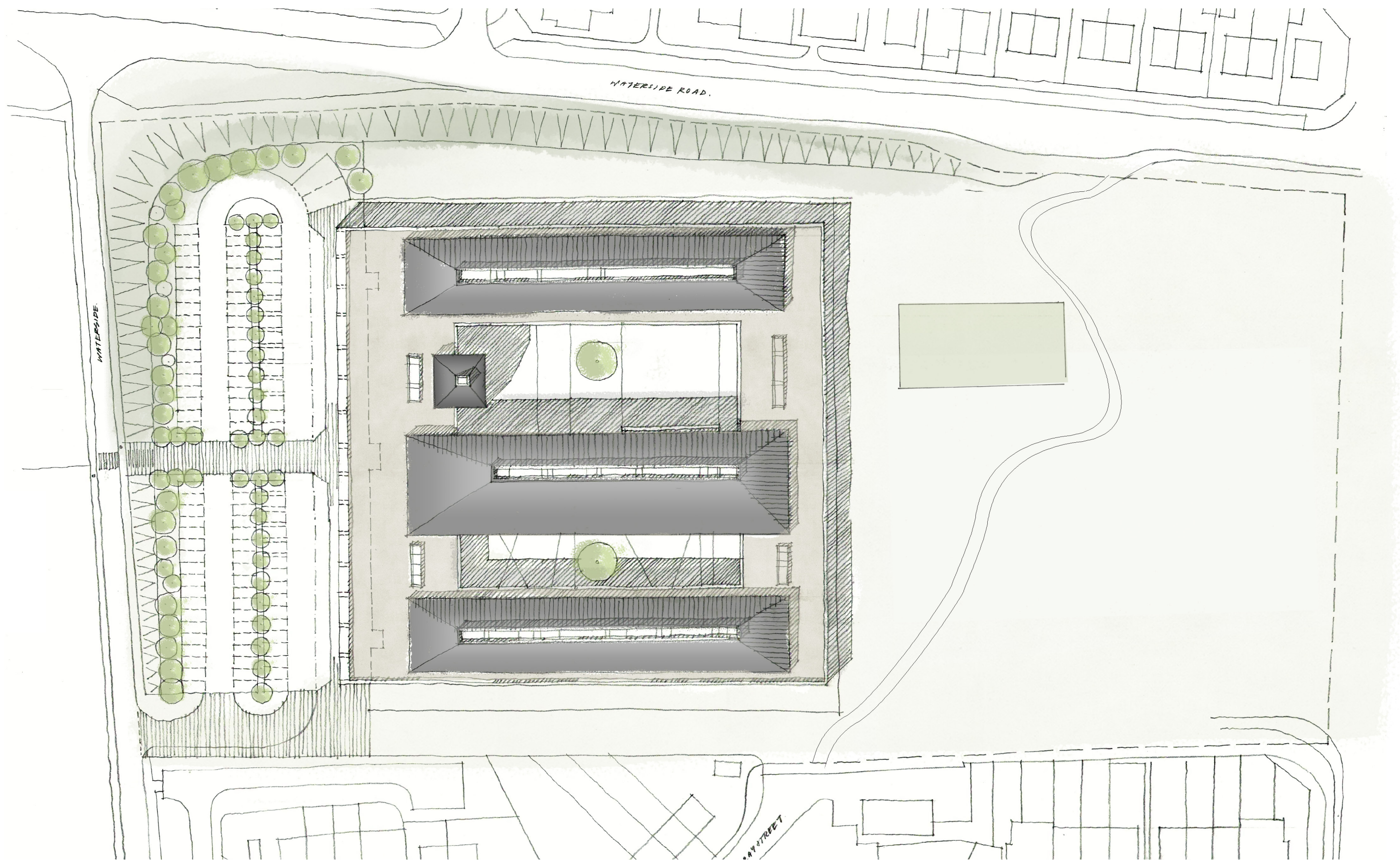



# Workshop 3 // The Floor Plan

## EDC ASN School

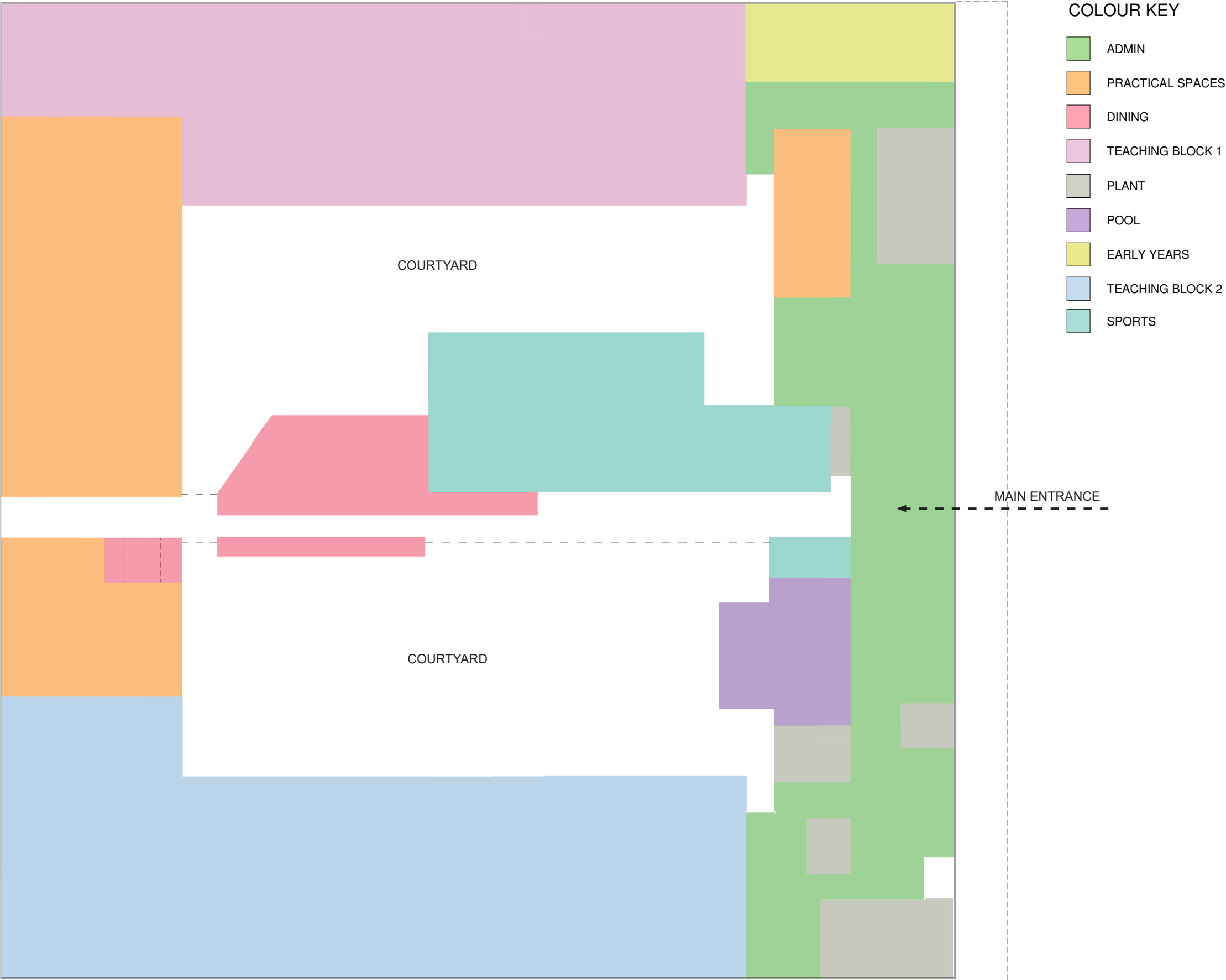

# Workshop 3 // Interactive Group 1

## Touring the School

- Arrange into 2 groups
- Using the Merkland plan as a guide, visit parts of the new school.
- Each colour coded represents an area within the new school and a real life area comparison
- Note comments / queries on the Merkland plan



# Workshop 3 // Future Workshops

## Key Features

